

Receipt: 9022549 **Division:** 1
Permit #: 103660- - **Water District:** 2
Well Name / #: **County:** ELBERT
Designated Basin: **Management District:**
Case Number:
WDID:

[-] Imaged Documents - Permit File

Document Name	Date Imaged	Annotated
Original File	12/05/2007	No

[-] Applicant/Contact

Applicant/Contact Name	Mailing Address	City/State/Zip
MILLER ELWOOD	STAR RTE BOX 282	ELIZABETH, CO 80107

[-] Location Information

Approved Well Location:

Q40	Q160	Section	Township	Range	PM	Footage from Section Lines	
SE	NW	25	6.05	65.0W	Sixth	2640 N	2640 W
Northing (UTM y):		4372243.9		Easting (UTM x):		533092.3	
Location Accuracy:		Spotted from section lines					

Subdivision Name

Filing Block Lot

Parcel ID: **Acres in Tract:**

[-] Permit Details

Date Issued: 12/08/1978 **Date Expires:**

Uses (See [Imaged Documents](#) for more information)

General Use(s): STOCK **Aquifer(s):** UPPER DAWSON

Special Use:

Area which may be irrigated:

Annual volume of appropriation: 1

Statute:

Cross Reference Permit(s): **Permit Number** **Receipt**

Comments:

[-] Construction/Usage Details

Well Construction Date: 04/30/1979 **Pump Installation Date:** 04/30/1979
Well Plugged: **1st Beneficial Use:** 05/16/1979

Elevation	Depth	Perforated Casing (Top)	Perforated Casing (Bottom)	Static Water Level	Pump Rate
	252	160	252	90	3

Driller	Lic #	Name	Address	Phone Number
	71	HAMACHER, T. R.	BOX 86 SIMLA, CO 80835	719-541-2460

CRJ-25-75

E

COLORADO DIVISION OF WATER RESOURCES

818 Centennial Bldg., 1313 Sherman St.

Denver, Colorado 80203

RECEIVED

OCT 17 1979

RECEIVED

AUG 05 1979

TYPE OR PRINT IN BLACK INK COPY OF ACCEPTED STATEMENT MAILED ON REQUEST.

STATE OF COLORADO

COUNTY OF Elbert

STATE ENGINEER

WATER RESOURCES STATE ENGINEER COLO.

- STATEMENT OF BENEFICIAL USE OF GROUND WATER
- AMENDMENT OF EXISTING RECORD
- LATE REGISTRATION

PERMIT NUMBER 103660

LOCATION OF WELL

THE AFFIANT(S) Elwood Miller
 whose mailing address is Star Rte - Box 282
 City Elizabeth CO 80107
(STATE) (ZIP)

County Elbert
SE $\frac{1}{4}$ of the NW $\frac{1}{4}$, Section 25
 Twp. 6 S Rng. 65 W 6 P.M.
(T. OR S.) (E. OR W.)

being duly sworn upon oath, deposes and says that he (~~they~~) is (~~are~~) the owner(s) of the well described hereon; the well is located as described above, at distances of 2640 feet from the north section line and 2640 feet from the

west section line; water from this well was first applied to a beneficial use for the purpose(s) described herein on the 16th

day of May, 1979; the maximum sustained pumping rate of the well is 3³/₁₅ gallons per minute, the pumping rate claimed hereby is 3³/₁₅ gallons per minute; the total depth of the well is 252 feet; the average annual amount

of water to be diverted is 1 acre-feet; for which claim is hereby made for windmill to water

Livestock purpose(s); the legal description of the land on which the water from this well is used is

Sec 25, T6 S, R65 W, 6 P.M. of which

0 acres are irrigated and which is illustrated on the map on the reverse side of this form; that this well was completed in compliance with the permit approved therefor; this statement of beneficial use of ground water is filed in compliance with law; he (they) has (have) read the statements made hereon; knows the content thereof; and that the same are true of his (their) knowledge.

(COMPLETE REVERSE SIDE OF THIS FORM)

Signature(s) Elwood Miller

Subscribed and sworn to before me on this 2nd day of June, 1979

My Commission expires: September 5, 1982

Sharon J. Garland
NOTARY PUBLIC

ACCEPTED FOR FILING BY THE STATE ENGINEER OF COLORADO PURSUANT TO THE FOLLOWING CONDITIONS:

FOR OFFICE USE ONLY

Court Case No. _____

Prior. _____ Mo. _____ Day _____ Yr. _____

Div. 1 City 20

Sec. _____ $\frac{1}{4}$. _____ $\frac{1}{4}$. _____ $\frac{1}{4}$.

Well Use 03

Dist. 02 Basin _____ Man. Dis. _____

Well drilled by Harmacher Well Works Lic. No. 71
 Permanent Pump installed by Harmacher Well Works Lic. No. 71
 Meter Serial No. _____ Flow Meter Date Installed May 16, 1979
 Owner of land on which water is being used Elwood Miller

THE LOCATION OF THE WELL MUST BE SHOWN AND FOR LARGE CAPACITY IRRIGATION WELLS THE AREA ON WHICH THE WATER IS USED MUST BE SHADED OR CROSS-HATCHED ON THE DIAGRAM BELOW.

This diagram represents nine (9) sections. Use the **CENTER SQUARE** (one section) to indicate the location of the well, if possible.

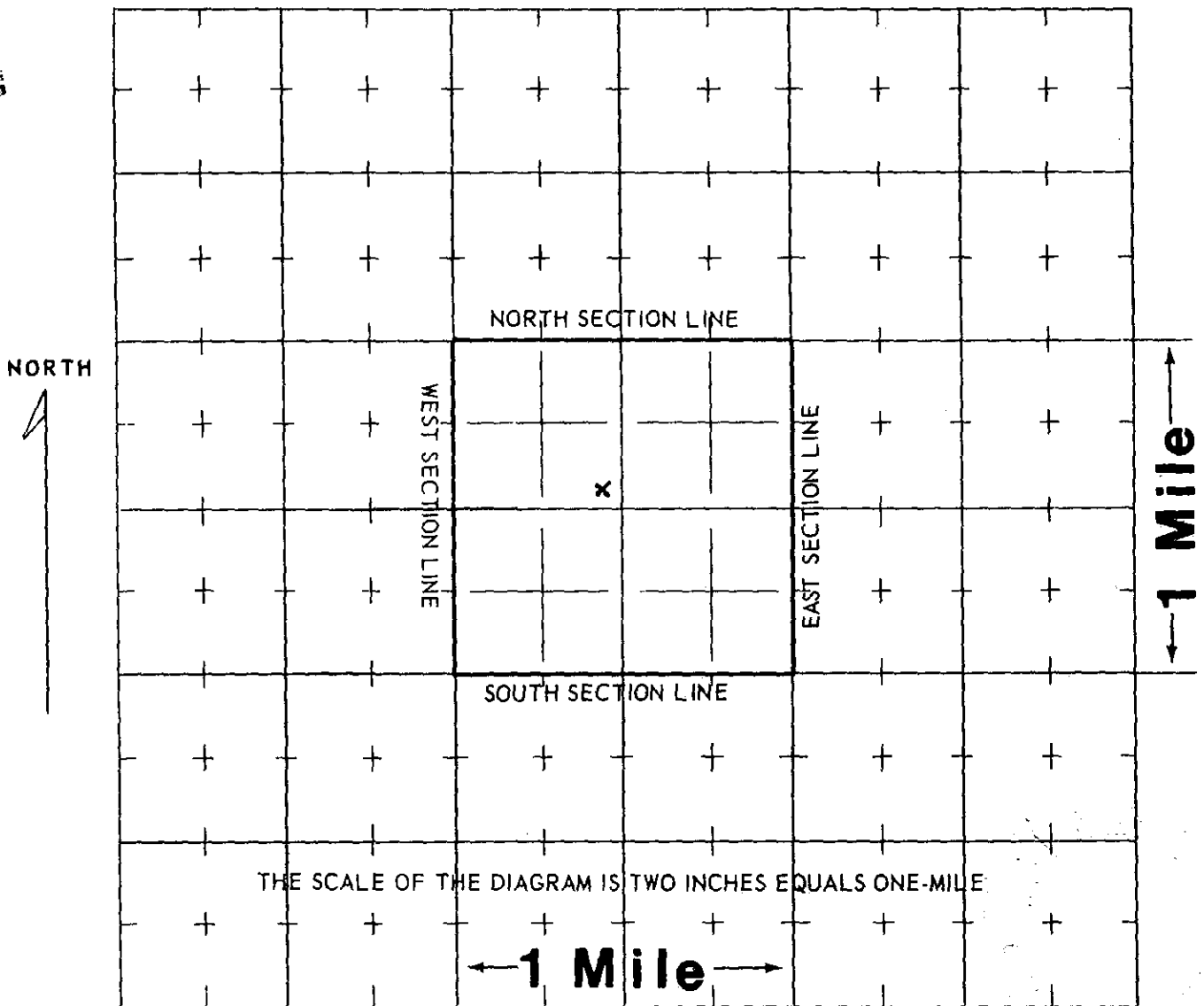

WATER EQUIVALENTS TABLE (Rounded Figures)

- An acre-foot covers 1 acre of land 1 foot deep.
- 1 cubic foot per second (cfs) . . . 449 gallons per minute (gpm).
- 1 acre-foot . . . 43,560 cubic feet . . . 325,900 gallons.
- 1,000 gpm pumped continuously for one day produces 4.42 acre-feet.
- 100 gpm pumped continuously for one year produces 160 acre-feet.

(WHITE AND PINK COPY TO BE FILED WITH THE STATE ENGINEER
 PINK COPY WILL BE RETURNED TO OWNER)

ew

COLORADO DIVISION OF WATER RESOURCES

1313 Sherman Street - Room 818
Denver, Colorado 80203

RECEIVED

OCT 02 1979

**WATER RESOURCES
ENGINEER**

THIS FORM MUST BE SUBMITTED
WITHIN 60 DAYS OF COMPLETION
OF THE WORK DESCRIBED HERE.
ON. TYPE OR PRINT IN BLACK
INK.

WELL COMPLETION AND PUMP INSTALLATION REPORT

PERMIT NUMBER 103660

WELL OWNER Elwood Miller SE ¼ of the NW ¼ of Sec. 25

ADDRESS Star Rt Boxx 282, Elizabeth Colo. 80107 T. 6 S. R. 65 W. 6th P.M.

DATE COMPLETED May, 19 79

HOLE DIAMETER

7 7/8 in. from 0 to 252 ft.

_____ in. from _____ to _____ ft.

_____ in. from _____ to _____ ft.

DRILLING METHOD Rotary

CASING RECORD: Plain Casing

Size 6 5/8 & kind Steel from 0 to 24 ft.

Size 4" & kind Plastic from 24 to 160 ft.

Size _____ & kind _____ from _____ to _____ ft.

Perforated Casing

Size 4" & kind Plastic from 160 to 252 ft.

Size _____ & kind _____ from _____ to _____ ft.

Size _____ & kind _____ from _____ to _____ ft.

GROUTING RECORD

Material Sand & Cement

Intervals 0-10

Placement Method poured

GRAVEL PACK: Size 5/16 -

Interval _____

TEST DATA

Date Tested May, 1979

Static Water Level Prior to Test 90 ft.

Type of Test Pump Bailed

Length of Test 1

Sustained Yield (Metered) 15

Final Pumping Water Level 130

WELL LOG

From	To	Type and Color of Material	Water Loc.
0	24	Clay	
24	30	Sand	
30	82	Dlay	
82	102	Clay & Sand Stone	
102	112	Sand Stone	
112	115	Clay	
115	122	Sand Stone & Clay	
122	142	Shale	
142	168	Sand Stone	
168	178	Shale	
178	222	Sand Stone	
222	232	S ^a nd Stone Shale	
232	252	S ^a nd Stone & Shale	

TOTAL DEPTH 252

Use additional pages necessary to complete log.

PUMP INSTALLATION REPORT

Pump Make 8" Dempster Mill
 Type 2 1/2" Cylinder
 Powered by wind HP
 Pump Serial No. _____
 Motor Serial No. _____
 Date Installed May 79
 Pump Intake Depth 150
 Remarks _____

WELL TEST DATA WITH PERMANENT PUMP

Date Tested May 1979
 Static Water Level Prior to Test 90
 Length of Test 1 Hours
 Sustained yield (Metered) 3 GPM
 Pumping Water Level 130
 Remarks _____

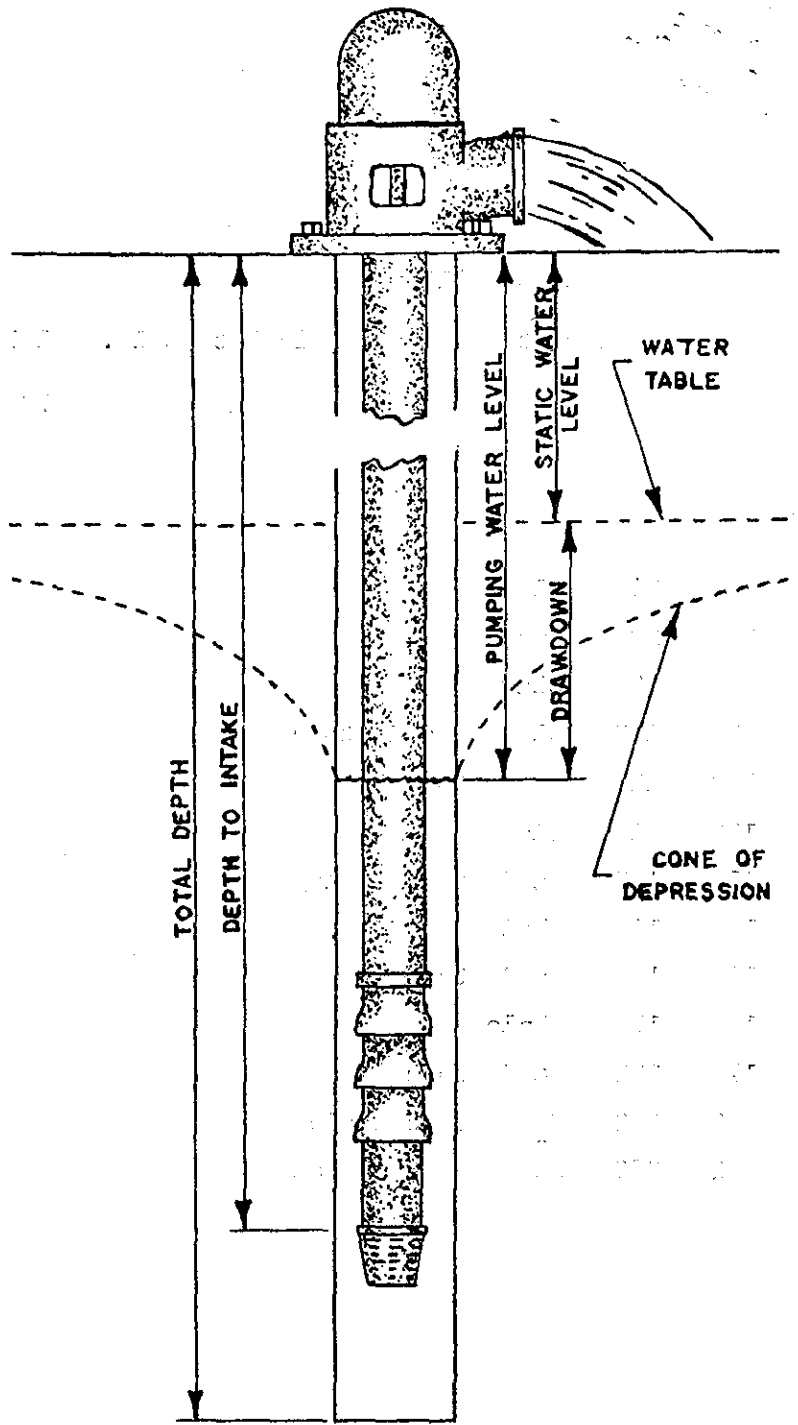

CONTRACTORS STATEMENT

The undersigned, being duly sworn upon oath, deposes and says that he is the contractor of the well or pump installation described hereon; that he has read the statement made hereon; knows the content thereof, and that the same is true of his own knowledge.

Signature J. R. Hamacher License No. 71
 State of Colorado, County of Elbert SS
 Subscribed and sworn to before me this 28 day of Aug, 19 79.
 My Commission expires: Dec 7, 19 82.
 Notary Public Bonnie Delores Hamacher

FORM TO BE MADE OUT IN QUADRUPPLICATE: WHITE FORM must be an original copy on both sides and signed. WHITE AND GREEN copies must be filed with the State Engineer. PINK COPY is for the Owner and YELLOW COPY is for the Driller.

COLORADO DIVISION OF WATER RESOURCES
818 Centennial Bldg., 1313 Sherman St., Denver, Colorado 80202

RECEIVED
OCT 30 1978
WATER RESOURCES
STATE ENGINEER
CORP.

RECEIVED
By 1029
SEP 15 1978
WATER RESOURCES
STATE ENGINEER
CORP.

PERMIT APPLICATION FORM

Application must be complete where applicable. Type or print in BLACK INK. No overstrikes or erasures unless initialed.

() A PERMIT TO USE GROUND WATER
() A PERMIT TO CONSTRUCT A WELL
FOR: () A PERMIT TO INSTALL A PUMP

() REPLACEMENT FOR NO. _____
() OTHER _____
WATER COURT CASE NO. _____

51A

(1) APPLICANT - mailing address

NAME Elwood Miller
STREET Star Route - Box 282
CITY Elizabeth, Colo 80107
(State) (Zip)
TELEPHONE NO. 646-4321

FOR OFFICE USE ONLY: DO NOT WRITE IN THIS COLUMN

Receipt No. 99676

Basin _____ Dist. _____

CONDITIONS OF APPROVAL

This well shall be used in such a way as to cause no material injury to existing water rights. The issuance of the permit does not assure the applicant that no injury will occur to another vested water right or preclude another owner of a vested water right from seeking relief in a civil court action.

(2) LOCATION OF PROPOSED WELL

County Elbert
SE 1/4 of the NW 1/4, Section 25
Twp. 6 S, Rng. 65 W, 6 P.M.
(N.S) (E.W)

APPROVED PURSUANT TO CRS 1973, 37-92-602
(3) (b) (II) AS THE ONLY WELL ON A TRACT

OF 35 ACRES OR MORE DESIGNATED AS 40
ACRES IN SE 1/4 NW 1/4; S25; T6S;
R65W; 6 P.M.

(3) WATER USE AND WELL DATA

Proposed maximum pumping rate (gpm) 15
Average annual amount of ground water to be appropriated (acre-feet): 1
Number of acres to be irrigated: NONE
Proposed total depth (feet): 150
Aquifer ground water is to be obtained from:

Owner's well designation _____

GROUND WATER TO BE USED FOR:

() HOUSEHOLD USE ONLY - no irrigation (0)
() DOMESTIC (1) () INDUSTRIAL (5)
() LIVESTOCK (2) () IRRIGATION (6)
() COMMERCIAL (4) () MUNICIPAL (8)
() OTHER (9) _____

DETAIL THE USE ON BACK IN (11)

APPLICATION APPROVED

PERMIT NUMBER 103660

DATE ISSUED DEC 08 1978

EXPIRATION DATE DEC 08 1980

(4) DRILLER

Name HAMACHER Well Works
Street Box 86
City Sidra, Colo 80835
(State) (Zip)
Telephone No. 541-2460 Lic. No. 71

Bruce E. DeBine
DEPUTY STATE ENGINEER

BY [Signature]

I.D. 1-02 COUNTY 20

(5) **THE LOCATION OF THE PROPOSED WELL** and the area on which the water will be used must be indicated on the diagram below. Use the CENTER SECTION (1 section, 640 acres) for the well location.

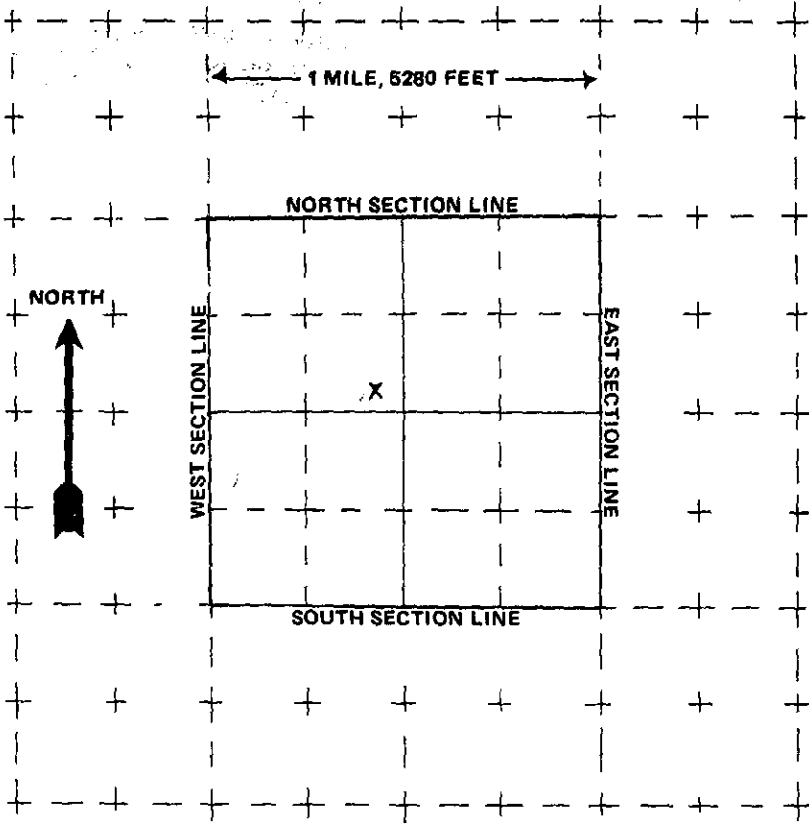

(6) **THE WELL MUST BE LOCATED BELOW** by distances from section lines.

2640 ft. from north sec. line
(north or south)

2640 ft. from west sec. line
(east or west)

LOT _____ BLOCK _____ FILING # _____

SUBDIVISION _____

(7) **TRACT ON WHICH WELL WILL BE LOCATED**

Owner: Elwood Miller

No. of acres 640. Will this be the only well on this tract? yes

(8) **PROPOSED CASING PROGRAM**

Plain Casing

4 1/2 in. from 0 ft. to 100 ft.

_____ in. from _____ ft. to _____ ft.

Perforated casing

4 1/2 in. from 100 ft. to 150 ft.

_____ in. from _____ ft. to _____ ft.

(9) **FOR REPLACEMENT WELLS** give distance and direction from old well and plans for plugging it:

WATER EQUIVALENTS TABLE (Rounded Figures)

An acre-foot covers 1 acre of land 1 foot deep

1 cubic foot per second (cfs) . . . 449 gallons per minute (gpm)

A family of 5 will require approximately 1 acre-foot of water per year.

1 acre-foot . . . 43,560 cubic feet . . . 325,900 gallons.

1,000 gpm pumped continuously for one day produces 4.42 acre-feet.

03362

(10) **LAND ON WHICH GROUND WATER WILL BE USED:**

Owner(s): _____ No. of acres: _____

Legal description: _____

(11) **DETAILED DESCRIPTION** of the use of ground water: Household use and domestic wells must indicate type of disposal system to be used.

LIVESTOCK (windmill)

(12) **OTHER WATER RIGHTS** used on this land, including wells. Give Registration and Water Court Case Numbers.

Type or right	Used for (purpose)	Description of land on which used

(13) **THE APPLICANT(S) STATE(S) THAT THE INFORMATION SET FORTH HEREON IS TRUE TO THE BEST OF HIS KNOWLEDGE.**

Elwood Miller

SIGNATURE OF APPLICANT(S)